



Product Information

Contact Us:

Wessel Duif – 071-897-9790

Banie Schoeman – 083-327-9507

sales@solarimports.co.za

www.solarimports.co.za

SKN-S Inverter:



Key Features:

- **Models available:**
 - 1 kW – 12V battery input
 - 3 kW – 24V battery input
- **PURE SINE WAVE**
- **Low Frequency Transformer Based Inverter**
- **Built-in 3 Stage P.F.C. AC Charger**
 - The PFC (Power Factor Corrected) feature is used to control the amount of power used to charge the batteries in order to obtain a power factor as close as possible to 1.
 - 3 Stages of Charging: Bulk Charging – Absorb Charging and Float Charging.
- **Real Work Horse!**
- **Great for Mobile Backup Power or to have Backup Power at Specific Appliances.**
- **Once started and up and running, batteries can be disconnected for maintenance purposes.**
- **Bypass-Mode – Batteries are Charged, and Load supplied from Utility. If Utility is disconnected, the Inverter will not transfer Load to Battery Backup.**
- **Normal Mode – Batteries are Charged, Load supplied from Utility. If Utility is disconnected, the Inverter will transfer load to Battery Backup.**
- **Select from 3 different Battery Charge Voltages and Select Max AC Charge Current.**

SKN-S INVERTER SPECIFICATIONS		
Specification	SKN-S 1KW	SKN-S 3KW
	DC Input	
Input Voltage	12V	24V
Minimum DC Start Voltage	10V	20V
	AC Bypass	
Nominal Input Voltage	230V	
Input AC Range	165V – 265V	
Frequency Range	47Hz – 53Hz	
Input Frequency	50Hz	
Bypass Output Voltage & Frequency	Same as Input	
Pass Through without Battery	Yes	
Max Bypass Overload Current	10A	30A
AC Efficiency	>95%	
Transfer Time	20ms (typical)	
	Charger	
Charging Voltage Input Range	195V – 255V	
Automatic Charge Mode – 3 Stages	Boost CC (constant current stage) Boost CV (constant voltage stage) Float (constant voltage stage)	
Nominal Charge Voltage	According to the Battery-Type setup	
Charging Current (A)	70A (Maximum)	
Charge Boost Voltage	14V – 15.5V	28V – 31V
Charge Floating Voltage	13.3V – 13.7V	26.6V – 27.6V
Over Charge Protection	≥ 15.7V (beeps)	≥ 31.4V (beeps)
Charge Short Circuit Protection	Circuit breaker	
	Inverter	
Capacity (VA)	1000	3000
Output Power (Watt)	1000	3000
Power Factor (PF)	1	1
Output Voltage	230VAC	
Output Frequency	50 ± 0.3Hz	
Wave Form	Pure Sine Wave	
Inversion Efficiency	>88%	
Low Battery Alarm	10.5VDC ± 0.3VDC	21.0VDC ± 0.3VDC
	Operating Environment	
Temperature	0°C – 40°C	
Humidity	5% - 95%	
Sea Level (m)	≤ 1500m	
	Dimensions	
Product Size	L438mm X W184mm X H181mm	
Weight (kg)	17.5kg	25kg

SUNPOLO Hybrid Inverter



Key Features:

- **Models available:**
 - 3 kW – 24V battery input
 - 5 kW – 48V battery input
- 5 kW Model can be Paralleled up to 9 Units
 - Parallel Card available separately.
- PURE SINE WAVE Inverter
- High Frequency Hybrid Inverter
- CAN RUN without Batteries!
- Built-in Wi-Fi to connect to Mobile App – Android only.
- 120 – 430VDC MPPT Operating Voltage – LESS Strings – LESS PV Wiring!
- Compatible with Lithium-Ion batteries
- Removable LCD Control Module

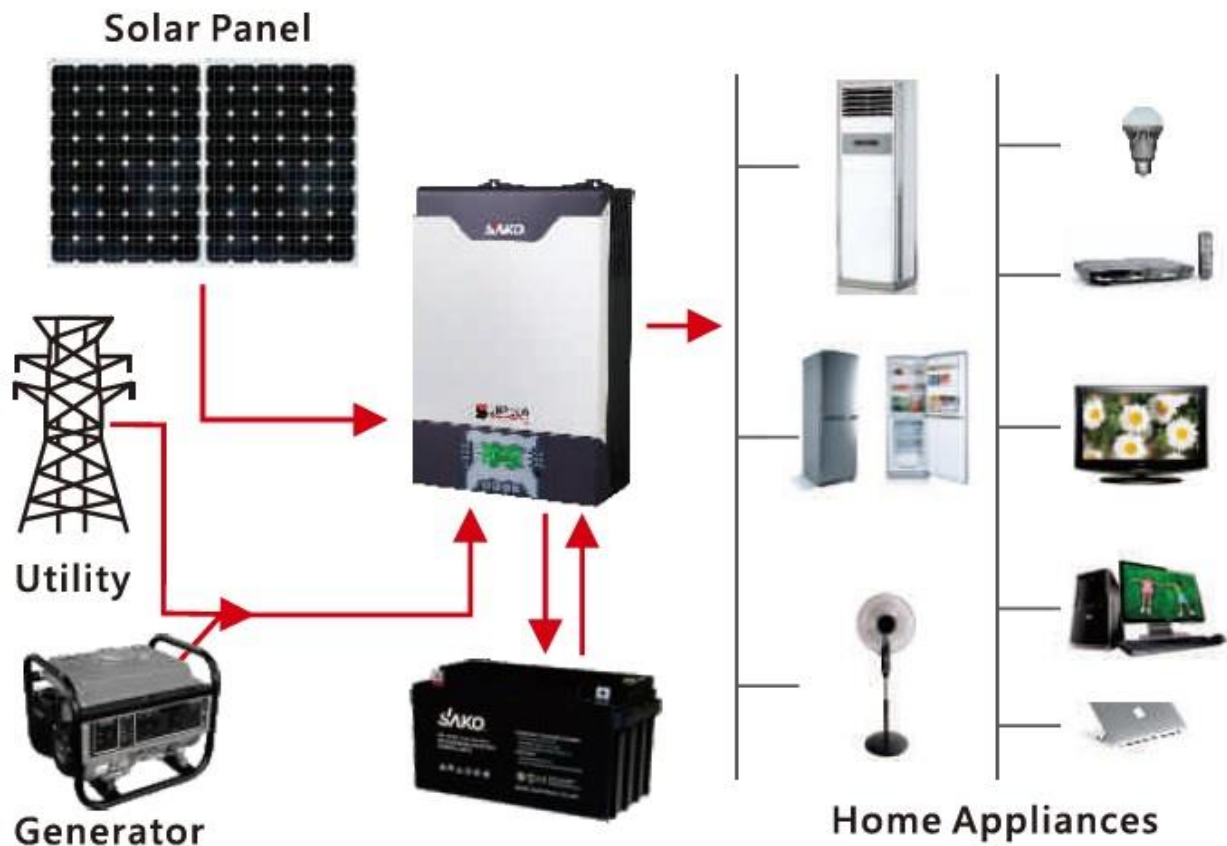

Information given by Inverter:

- PV energy generated today and Load Output energy today
- PV energy generated this month and Load Output energy this month
- PV energy generated this year and Load Output energy this year
- PV energy generated total since installation and Load Output energy since installation

SUNPOLO INVERTER SPECIFICATIONS		
Model	Sunpolo – 3KW	Sunpolo – 5KW
Rated Power	3KW	5KW
	Input	
Input Voltage	230V	
Selectable Voltage	176 – 280VAC at 100% load 110V-280VAC at 50%load	
Frequency Range	50/60Hz (Auto Sensing)	
	Output	
AC Voltage regulation (Battery Mode)	230VAC ± 3%	
Surge Power	6400VA for 5 seconds	10400VA for 5 seconds
Efficiency (Peak)	>95% (Rated R load, Battery fully charged)	
Transfer Time	10ms (For PC's), 20ms (For Home Appliances)	
Wave Form	Pure Sine Wave	
	Battery	
Battery Voltage	24VDC	48VDC
Floating Charge Voltage	27VDC	54VDC
Overcharge Protection	32VDC	64VDC
	Solar Charger & AC Charger	
Solar Charger Type	MPPT	
Maximum PV Array Open Circuit Voltage	450VDC	
Maximum PV Array Power	4000W	5000W
MPP Range @ Operating Voltage	120 – 430VDC	
Maximum Solar Charge Current	80A	
Maximum AC Charge Current	80A	
	Physical	
Dimension (mm)	H471 X W303 X D146	H530 X W377 X D217
Nett Weight (kg)	11.5kg	12.2kg
Communication Interface	Removable OTG USB/RS232/RS458/BLE/Dry Contact, BMS interface	
Parallel Function	Not available	9 pcs in Parallel
	Operating Environment	
Operating Temperature	-10°C to 50°C	
Humidity	5% - 95% (Relative Humidity – Non-Condensing)	
Storage Temperature	-15C to 60°C	

SLZS ALL-IN-ONE COMBO LOAD SHEDDING SOLUTION – PURE SINE WAVE



- **Models Available:**
 - **SLZS-1000VA – 800W**
 - **SLZS-1500VA – 1200W**
- **All-in-One Unit which includes: Inverter, AC charger, PWM Solar Charger and batteries.**
- **Inverter: PURE SINEWAVE, Transformer based, Isolated output, reliable and safe.**
- **LCD display plus buzzer alarm design, clearly showing work status.**
- **Wide AC input range – 110VAC – 270VAC**
- **Compatible to both Grid and Generator Power.**
- **Smart battery charger and management.**
- **Auto Charging and Switching.**
- **Highly Efficient DC-to-AC conversion. Minimizing Energy loss and self-powering consumption.**
- **Bypass mode available to not supply power when not needed.**
- **3 Types of output: 230V Socket, 12VDC port, 5VDC USB port. Can connect DC load directly.**
- **All round protection functions: Overload/Short Circuit/High battery voltage/Low battery voltage/high temperature.**

SLZS RANGE TECHNICAL PARAMETERS		
Model	SLZA-1000VA	SLZS-1500VA
INVERTER, AC CHARGER AND BATTERY		
Rated Output Power	800W	1200W
AC output voltage / Frequency	220V ±10% 50HZ ±2%	220V ±10% 50HZ ±2%
Output Wave Form	Pure Sine Wave	Pure Sine Wave
AC input voltage range (VAC)	100 – 270V	90 – 265V
Inverter Efficiency	≥90%	≥90%
Transfer Time	10ms typical	20ms typical
Battery Input Voltage (VDC)	10.8 – 14V	10.8 – 14V
DC Port Output voltage (Follows battery Voltage) (VDC)	10.8 – 14V	10.8 – 14V
USB Port Output voltage (VDC)	5V ±0.5V	5V ±0.5V
Battery Capacity (AGM Battery)	12V/100AH	12V/150AH
AC charger max charge current	13A ±2A	30A ±2A
Average charge voltage	14VDC	14VDC
Float charge voltage	13.8VDC	13.8VDC
Low voltage alarm	11.2VDC	11.2VDC
Low voltage protection	≤10.8V	≤10.8V
Over voltage protection	≥14.5V	≥14.5V
PWM Solar Charge Controller		
Max Charge Current	50A	50A
Max Solar Panel Input Power	900W	900W
Solar Panel Input Voltage Range	18-25VDC (Suggested to use 150W 36Cell Panel)	
Average Charge Voltage	14.4V	14.4V
Float Charge Voltage	13.8V	13.8V
Battery's Over voltage Protection and recovery voltage	14.4V/13.6V	14.4V/13.6V
Set Range of Voltage when Low Voltage Off	10.8V – 11.6V	10.8V – 11.6V
Set Range of Voltage when Low Voltage On	12.2V – 13.2V	12.2V – 13.2V
OUTPUT PORTS		
AC220V Socket	220V/10A * 2PCS	220V/10A * 2PCS
DC12V	12V/3A * 4PCS	12V/3A * 4PCS
USB	5.0V * 2PCS	5.0V * 2PCS
OTHER		
Display	LCD & LED	
Low Voltage Alarm	Buzzing every 2 Seconds	
Overload Alarm	Buzzing every 0.5 Seconds	
Working Temperature	0° - 50°C	
Storage Temperature	-10°C - 50°C	
(Carton Size) mm	642 X 491 X 284	672 X 528 X 284
Weight (NW kg)	54.0kg	68.2kg

BATTERIES – LITHIUM- LiFePO4



- **Models Available:**
 - 24V100AH
 - 48V100AH
- **New Improved Cells**
- **Minimum 3000 Cycles**
- **Now with built-in Circuit breaker for easy resetting**
- **Built-in Over-Charge and Over-Discharge protection**
- **2 Year Warranty**

SAKO LITHIUM IRON PHOSPHATE BATTERIES		
Model	24V100AH	48V100AH
Battery Type	LiFePO4	
Nominal Battery Voltage (V)	25.6 VDC	51.26 VDC
Fast Charge Voltage (V)	28.0 – 28.86 VDC	56.0 – 57.66 VDC
Float Charge Voltage (V)	25.66 VDC	55.26 VDC
Over Charge Protection Voltage (V)	29.26 VDC	58.46 VDC
Over Discharge Protection Voltage (V)	20.0 – 22.46 VDC	40.0 – 44.86 VDC
Charge Current (A)	100A	100A
Discharge Current (V)	100A Max.	100A Max.
Cell Equalizer Current (A)	1 – 5A Max.	
	Protection	
Protection	Over-Charge protection. Over-Discharge protection, Over-Current protection, Short-Circuit Protection, Over-Temperature protection	
	Dimensions	
L X W X H (Product size) mm	L472 X W290 X H182	L773 X W285 X H180
L X W X H (Product size) mm	L530 X W360 X H222	L830 X W358 X H222
Weight (NW kg)	25kg	51.0kg
Weight (GW kg)	25.5kg	52.0kg
	Operating Environment	
Operating Temperature	-10°C to 50°C	
Humidity	0% - 95% (Relative Humidity – Non-Condensing)	
Sea Level (m)	<1500m	

MONOCRYSTALLINE SOLAR PANELS

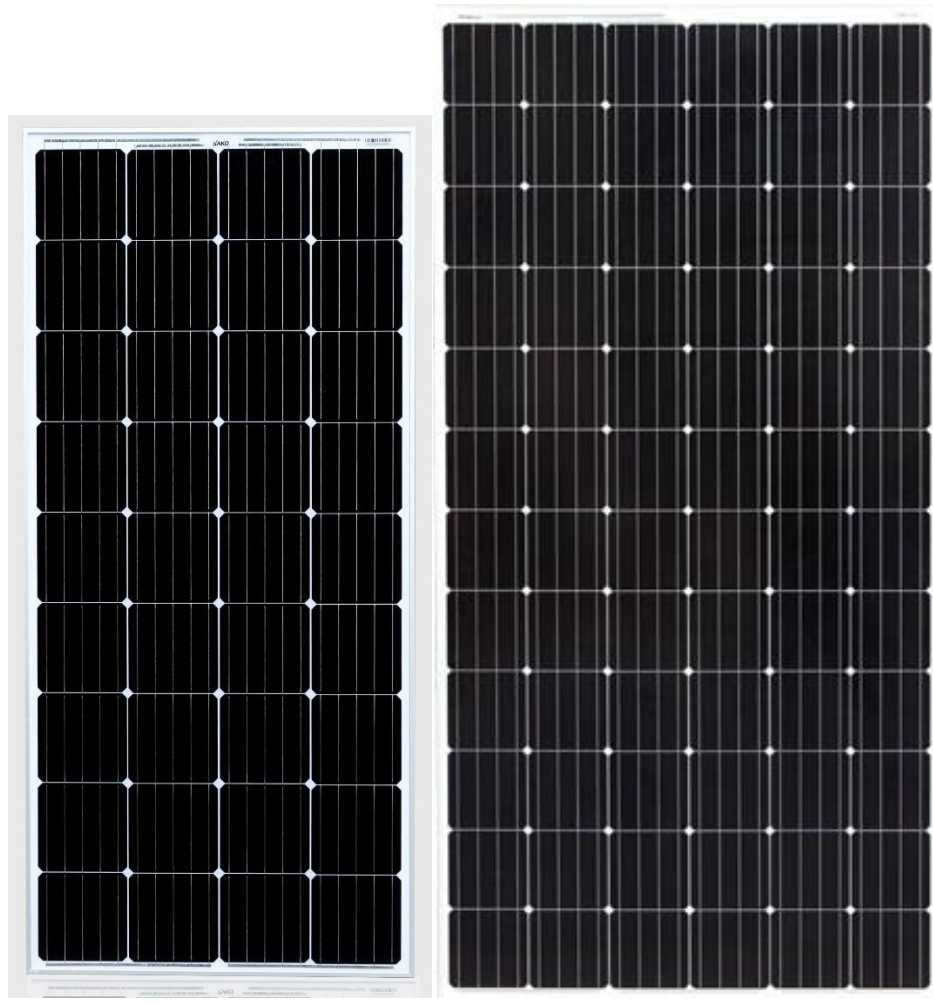

- **Models Available:**
 - **150W – Suggested to be used with SLZS Inverter Range**
 - **250W – Suggested to be used with SUNPOLO Range**
- **Tempered and high transparent low-iron glass.**
- **Excellent Low Light performance.**
- **Special and advanced module sealing technology.**
- **Durable PV Modules**
- **Module warranty:**
 - **25-year limited warranty of 80% power output**
 - **10-year limited warranty of 90% power output**
 - **5-year limited warranty of material and workmanship.**

SAKO SOLAR PANELS SPECIFICATIONS		
Model	150W	250W
ELECTRICAL PARAMETERS AT STANDARD TEST CONDITIONS (STC)		
Output Power	150W	250W
Module efficiency	17.6%	15.4%
Voltage at P Max - Vmp	18.09V	29.8V
Current at P Max - Imp	8.29A	8.39A
Open Circuit Voltage - Voc	22.25V	37.6V
Short Circuit Current - Isc	8.87A	8.92A
THERMAL CHARACTERISTICS		
Nominal operating Cell Temperature	46 ±2 °C	46 ±2 °C
Temperature coefficient of P Max	-0.42%/°C	-0.42%/°C
Temperature coefficient of Voc	-0.32%/°C	-0.32%/°C
Temperature coefficient of Isc	0.05%/°C	0.05%/°C
Temperature coefficient of Vmp	-0.42%/°C	-0.42%/°C
Operating Conditions		
Max System Voltage	1000VDC	1000VDC
Max Series Fuse Rating	15A	15A
Limiting Reverse Current	15A	15A
Operating Temperature Range	-40°C - 85°C	-40°C - 85°C
Max Static Load – Front (e.g. Snow)	5400Pa	5400Pa
Max Static Load – Back (e.g. Wind)	2400Pa	2400Pa
Max Hailstone impact (diameter/velocity)	25MM/23m/s	25MM/23m/s
Construction materials		
Front Cover (Material/Thickness)	Low-Iron tempered glass / 4.0mm	Low-Iron tempered glass / 4.0mm
Cells (Quantity / Material / Dimension / Number of busbars)	36 / multi-crystalline silicon / 156mmX156mm / 4 or 5	36 / multi-crystalline silicon / 156mmX156mm / 4 or 5
Frame (Material / Colour / Anodization Color / Edge Sealing)	Anodized aluminium alloy / Silver / Clear / Silicon or tape	Anodized aluminium alloy / Silver / Clear / Silicon or tape
Junction Box (Protection Rating)	≥IP65	≥IP65
Cable Length / Cross-section diameter	1100mm / 4mm ²	900mm / 4mm ²
Plug Connector (Type / Protection Rating)	MC4 / IP67	MC4 / IP67
Dimensions (L / W / H)	1480mm/680mm/40mm	1640mm/990mm/40mm
Weight	11.05kg	18,5kg

 <p>Solar IMPORTS Wholesalers of SAKO Solar Systems SOLE DISTRIBUTORS IN SA</p> <small>a Division of Fanel Decor Plus (Pty) Ltd Reg. No. 2005/0016512/07 VAT No. 490023639</small>	<p>www.solarimports.co.za</p>	<p>P.O. Box 205, Ruimsig, 1732 548 Heritage View Drive Muldersdrift, Gauteng South Africa E: sales@solarimports.co.za T: 071 897 9790</p>
---	-------------------------------	---

WARRANTY CERTIFICATE

This is a written guarantee, issued to the purchaser of any Inverter or Lithium battery, promising to repair or replace it if necessary, within the time periods as specified below:

WARRANTY ON INVERTERS:

12 MONTHS starting 30 days after the Client/Purchaser Invoice date.

WARRANTY ON LITHIUM BATTERIES:

24 MONTHS starting 30 days after the Client/Purchaser Invoice date.

This warranty is subject to the installation being installed by a qualified electrician with a Certificate of Compliance issued to confirm the installation is done as per regulations.

Signed:



Banie Schoeman
Director/Owner